



Meetings



QUICK FACTS:

- Georgia Coast's most central conference center – centrally located between Savannah, Pooler, Statesboro & Brunswick.
- 12 Miles from Savannah & 17 Miles from Savannah/Hilton Head International Airport
- Easily accessible from main highways (I-95 & I-16)
- Over 20 branded hotels within a 2-6 mile radius
- Secluded & private
- 10,000 Square-feet of flexible indoor meeting space including 10 breakouts
- For meetings & groups of all sizes up to 350 guests
- 6000 Square-feet of outdoor space
- 4000 Square-foot ballroom with floor to ceiling windows allowing for natural light if you choose or shades can be pulled down
- State-of-the-art audio visual equipment & onsite technical support as needed
- Fully equipped business center
- Capability & inventory for all different meeting sets
- Complimentary parking
- LEED Registered Meeting center
- Follow IACC Standards

CAPACITY/FLOOR PLAN



520 Cedar Street
Richmond Hill, GA 31324

(912) 445-0043

www.richmondhillcitycenter.com



goo.gl/maps/622rCnhzdF62

FIRST FLOOR

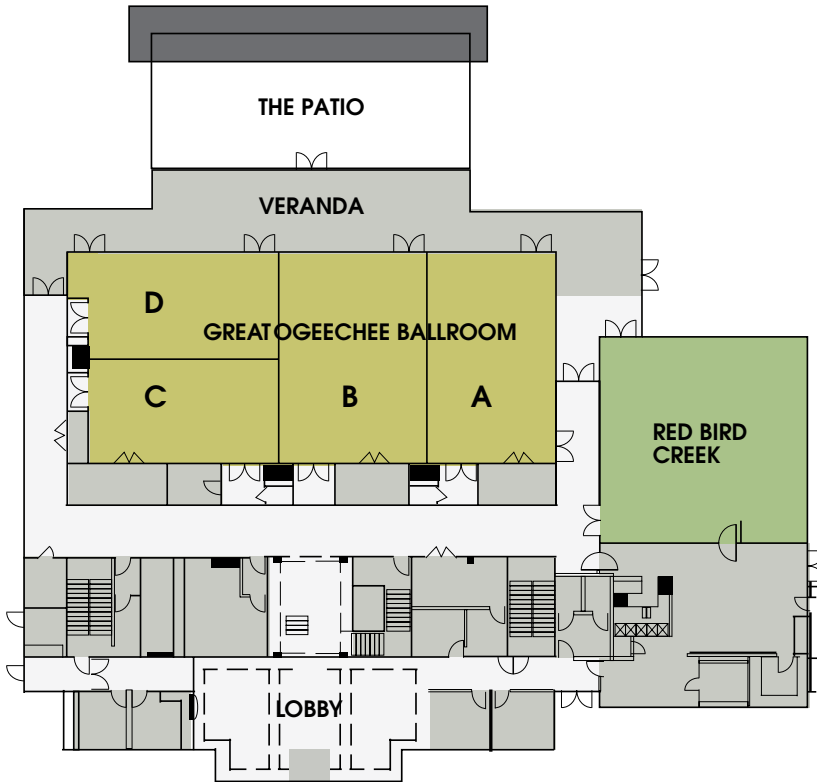

SECOND FLOOR

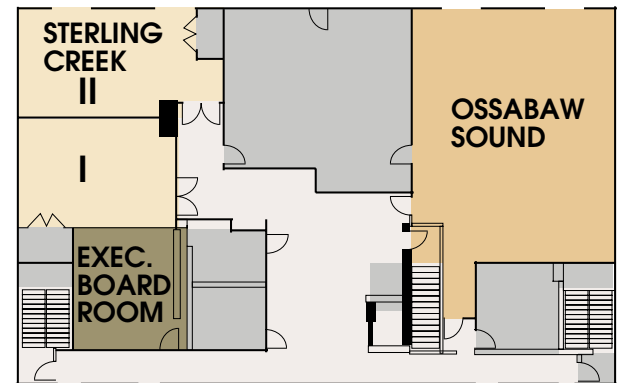

Capacity per seating arrangement

NAME OF SPACE	SQ. FT.	DIMEN.	THEATER	CLASSROOM	BANQUET ROUNDS	COCKTAILS
GREAT OGEECHEE BALLROOM	3977	96.3' X 41.3'	400	270	320	400
Gallery A	1061	25.7' X 41.3'	100	70	80	100
Gallery B	1193	28.9' X 41.3'	110	78	100	110
Gallery C	863	41.7' X 20.7'	80	50	60	80
Gallery D	863	41.7' X 20.7'	80	50	60	80
Gallery AB	2255	54.6' X 41.3'	220	150	200	220
Gallery CD	1722	41.7' X 41.3'	170	112	120	170
Gallery BCD	2916	70.6' X 41.3'	290	190	220	290
RED BIRD CREEK	1640	41.7' x 39.9'	N/A		N/A	160
STERLING CREEK	890	25.1' x 35.4'	80	50	60	80
Gallery I	445	25.1' x 17.7'	40	30	30	40
Gallery II	445	21.1' X 17.7'	40	30	30	40
OSSABAW SOUND	1244	32.8' x 41'	120	75	100	120
EXECUTIVE BOARD ROOM	350	18.1' x 19.2'	N/A	N/A	N/A	N/A
THE VERANDA	2004		N/A	N/A	60	200
THE PATIO	2700	60' x 45'	200	N/A	160	200